

PRODUCT INFORMATION PACKET



Model No: B228SE
Catalog No: B228SE
Pool Pump Motor, 1.0 HP, 1 Ph, 60 Hz, 230/115 V, 3600 RPM, U56J Frame, DP



Regal and Century are trademarks of Regal Rexnord Corporation or one of its affiliated companies.
©2024 Regal Rexnord Corporation, All Rights Reserved. MC017097E





Nameplate Specifications

Phase	1	Output HP	1.0 Hp
Output KW	0.75 kW	Voltage	230/115 V
Speed	3450 rpm	Service Factor	1
Frame	U56J	Enclosure	Drip Proof
Thermal Protection	Thermally Protected	Ambient Temperature	50 °C
Frequency	60 Hz	Current	6.0/12.0 A
Duty	Continuous	Insulation Class	B
UL	Recognized	CSA	Y
Number of Speeds	1		

Technical Specifications

Electrical Type	Permanent Split Capacitor, Single Or Dual Voltage	Poles	2
Rotation	Counterclockwise Pump End	Mounting	C Face
Motor Orientation	Horizontal	Drive End Bearing	Ball
Opp Drive End Bearing	Ball	Frame Material	Rolled Steel
Shaft Type	7/16 THREADS	Overall Length	12.81 in
Frame Length	7.00 in	Shaft Diameter	0.625 in
Shaft Extension	2.57 in		
Connection Drawing	02282603-001	Outline Drawing	B228SE

This is an uncontrolled document once printed or downloaded and is subject to change without notice. Date Created:05/22/2024

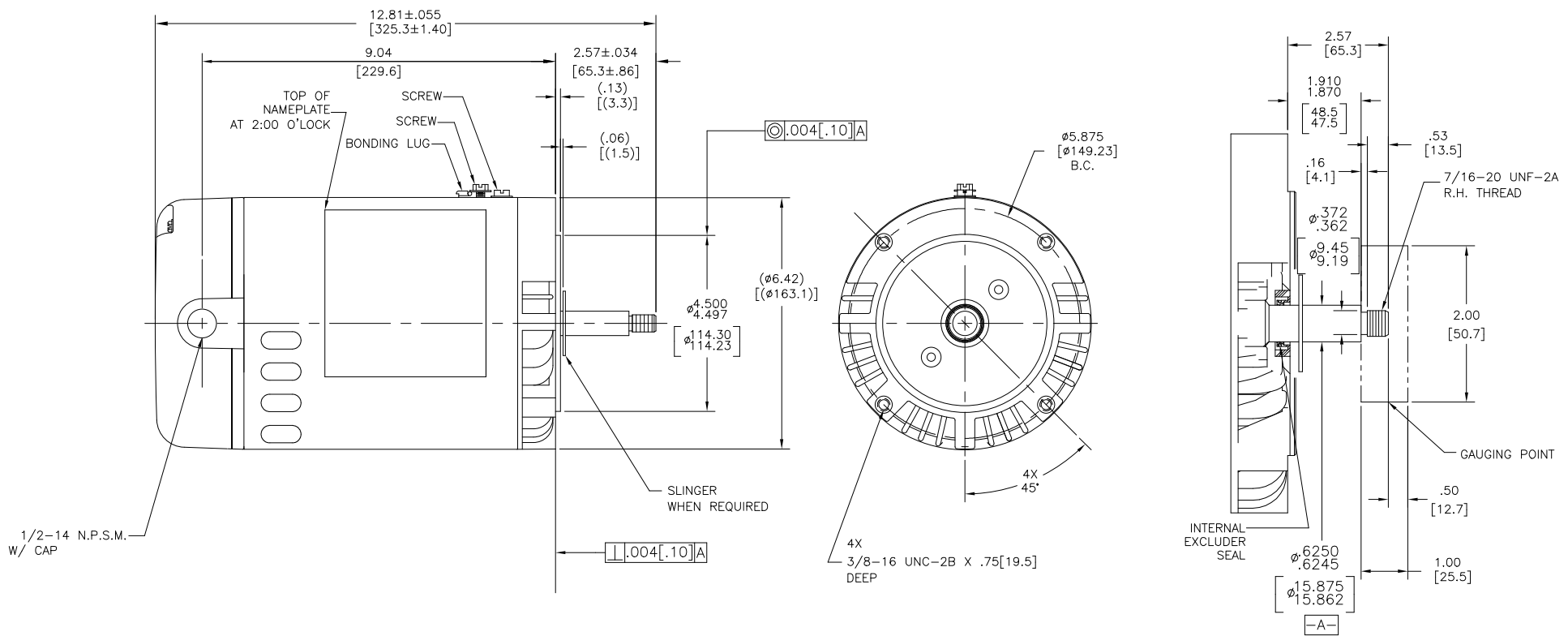

NAMEPLATE DATA	EXTERNAL CONNECTION DIAGRAM	NOTES
MODEL: 184981 CUST PN: B228SE HP: 1.0 SF: 1.0 ROT: CCWPE RPM: 3450 TYPE: CX CODE: G FORM: KJM FRAME: U 56 J VOLTS: 230/115 AMPS: 6.0/12.0 MAX AMPS: --- SF AMPS: --- PH: 1 HZ: 60 INS: B AMB: 50°C DUTY: CONT ENCLOSURE: DP THERMALLY PROTECTED	<p>DUAL VOLTAGE</p> <p>02282603-001</p> <p>HIGH VOLT CONNECTION AS SHOWN. TO CHANGE TO LOW VOLT, MOVE THE BLACK PLUG TO ALIGN THE ARROWS AT THE 115V LOCATION. USE COPPER CONDUCTORS ONLY. INSTALL MOTOR WITH VENTS DOWN. ACCEPTABLE FOR FIELD WIRING</p>	<ol style="list-style-type: none"> SHAFT RUNOUT NOT TO EXCEED .002 [.05] T.I.R. FOR THREADED SHAFT EXT. MATING PARTS SHOULD BE RELIEVED ONE THREAD TO CLEAR FILLET. FOR THREADED SHAFT EXT. ECCENTRICITY OF THREADED PORTION OF SHAFT IS HELD WITHIN .004 [.10] TOTAL GAGE READING WITH THE INDICATOR ON O.D. OF GROUND RING GAGE AS SHOWN. THE GAGE BEING STATIONARY WITH RESPECT TO THE ROTOR. END PLAY NOT TO EXCEED .010 [.25] MEASURED WITH NO THRUST. CTQ REQUIREMENT SEE EP000105-008. RoHS & REACH ETC REQUIREMENT SEE EP000014

PERFORMANCE CURVE	APPROVED SAMPLE		
16345111	---		
UL COMPONENT	CSA		
FILE#	CCN#	FILE#	GUIDE#
E14663	XEWRZ	LR4642	4211-01
CUSTOMER	DISTRIBUTION		

CRITICAL TO QUALITY CHARACTERISTICS(CTQs) (P) PROCESS (E) ENGINEERING (A) APPLICATION (R) REGULATORY (L) LIFE	DRAWING REVISION: K ECO: ECR-0234051 REVISION BY: S JIMENEZ APPROVED BY: S JIMENEZ DATE: 5-16-2024 DATE: 5-16-2024	TOLERANCES UNLESS OTHERWISE SPECIFIED DEC. INCH mm ANGLE .X ±0.1 [±2.5] ±0.5° .XX ±0.02 [±0.51] .XXX ±0.005 [±0.127] .XXXX ±0.0005 [±0.0127] REMOVE BURRS & BREAK SHARP EDGES .003/.015 [0.076/.381] CORNER FILLETS .02 [.51] MACHINED SURFACES 125/ mm 3/2 mm SHOWN IN [BRACKETS]	DRAWN BY: AS DATE: 09-15-2010 APPROVED BY: TZ DATE: 09-15-2010 REFERENCE: MATERIAL PROCESS/FINISH SIZE DWG NO: B228SE THIRD ANGLE PROJECTION	REGAL™ Regal Beloit America, Inc. DESCRIPTION: MODEL-CFHP-56FR OUTLINE SHEET 1
--	---	---	--	--

AO Smith

Performance Down Project: 0444227 (High Speed)

Thursday, September 02, 2004 05:50 AM

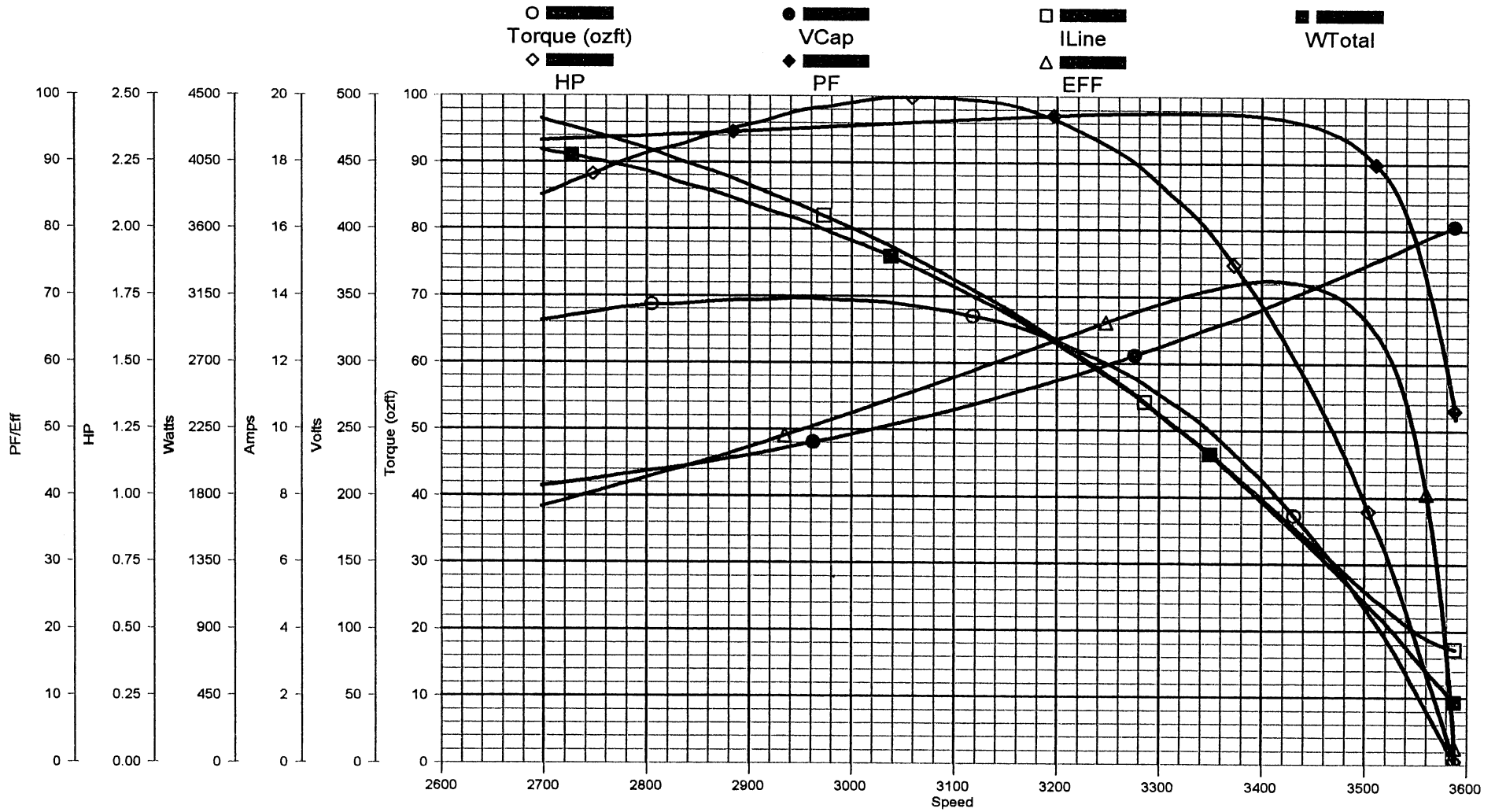

TRACKING #: 10028999
 SBU: Pump
 ENGINEER: DWAYNE FOX
 TECHNICIAN: DAN
 BENCH: 2
 TORQUE CELL: 350 lb-in
 NP RPM: 3450
 # SPEEDS: 1
 MOTOR #: 1
 TYPE: CX

CUSTOMER:
 MODEL: 0444227A
 FRAME: P56Y
 PHASES: 1
 HP:
 VOLTS: 230.0
 HERTZ: 60
 START CAP: 0.00
 RUN CAP: 25.00
 COMMENT3:

DESCRIPTION: OFFSET
 BDT: 69.67
 MT: 69.67
 SF: 35.10
 LRT: 0.00
 LRA: 0.00
 PUT: 0.00
 COMMENT1:
 COMMENT2:
 COMMENT4:

LOCK AMPS: 27.2A
LOCK TORQUE: 12.0 oz-ft
BREAKDOWN TORQUE: 69.6 oz-ft

AO Smith

Performance Up Project: 0444227 (High Speed)

Thursday, September 02, 2004 06:03 AM

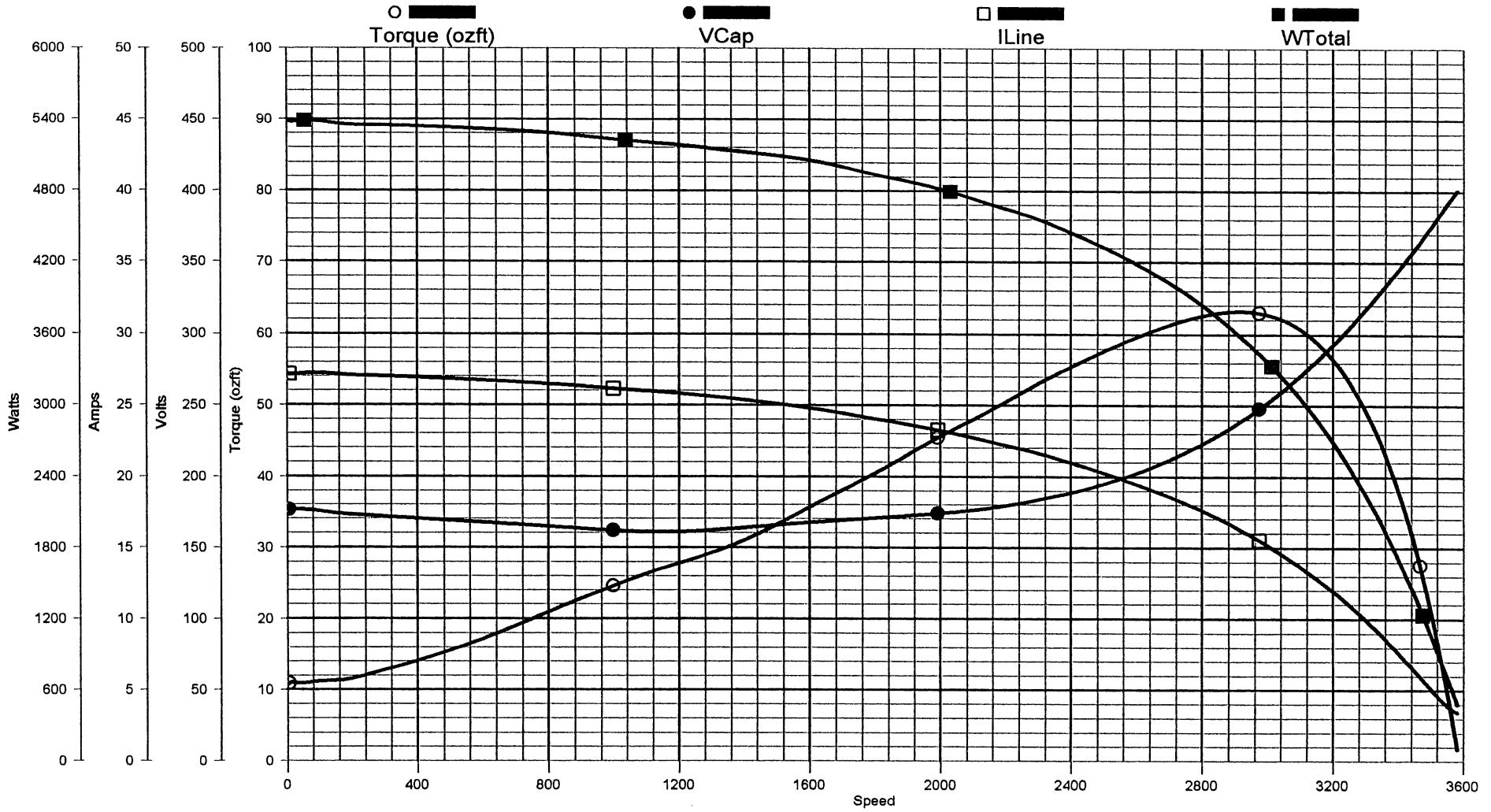

TRACKING #: 10028999
 SBU: Pump
 ENGINEER: DWAYNE FOX
 TECHNICIAN: DAN
 BENCH: 2
 TORQUE CELL: 350 lb-in
 NP RPM: 3450
 # SPEEDS: 1
 MOTOR #: 1
 TYPE: CX

CUSTOMER:
 MODEL: 0444227A
 FRAME: P56Y
 PHASES: 1
 HP:
 VOLTS: 230.0
 HERTZ: 60
 START CAP: 0.00
 RUN CAP: 25.00
 COMMENT3:

DESCRIPTION: 0-SYNC
 BDT: 63.15
 MT: 63.15
 SF: 35.10
 LRT: 10.67
 LRA: 27.14
 PUT: 10.67
 COMMENT1:
 COMMENT2:
 COMMENT4: